

NOTES:

- LEVELS ARE IN TERMS OF THE MOTURIKI DATUM.
- ORIGIN OF LEVELS TCC BENCHMARK BM 1020 RL 14.63m.
- METHOD OF SURVEY: GPS
- ALL WORKS WERE CARRIED OUT TO TCC IDC 2011 STANDARDS.
- ALL PVC PIPE WATERMAINS ARE PVC PN9 PIPE.
- REFER TO TABLE FOR PE PIPE DETAILS
- WHERE MULTIPLE WATER METERS ARE BANKED AT THE BOUNDARY 2 OR 3 WATER METERS HAVE BEEN PLACED IN EACH BOX.
- NO VALVES OR HYDRANTS ARE LOCATED IN THE CARRIAGEWAY.
- ALL WATER METERS HAVE BEEN INSTALLED WITHIN THE ROAD RESERVE.
- ALL BURIED AS BUILT INFORMATION SUPPLIED BY HIGGINS CONTRACTORS LTD.

LEGEND

- EXISTING WATERMAIN
- - - AS BUILT WATER MAIN
- ⊠ EXISTING SLUICE VALVE
- ⊠ EXISTING HYDRANT
- ⊠ AS BUILT SLUICE VALVE
- ⊠ AS BUILT GATE VALVE
- ⊠ AS BUILT HYDRANT
- ⊠ AS BUILT WATER METER

WATER METER SCHEDULE							
LOT	SERIAL NO.	mE	mN	RL	Front	Side	Initial Reading
931	15M 1552376	368083.14	801010.20	12.12	0.57	1.01	0.111
932	15M 1552377	368083.18	801011.25	12.12	0.53	0.04	0.101
933	15M 1552383	368084.54	801030.64	12.01	0.41	0.52	0.101
934	15M 1552382	368084.62	801031.67	12.02	0.41	0.51	0.111
935	15M 1552378	368086.26	801053.52	11.89	0.37	0.58	0.107
936	15M 1552380	368086.37	801054.78	11.85	0.39	0.68	0.108
937	15M 1552379	368088.43	801079.43	11.74	0.56	0.58	0.111
938	15M 1552381	368088.60	801080.76	11.74	0.63	0.76	0.111
939	15M 1552360	368090.12	801105.48	11.59	0.26	0.48	0.111
940	15M 1552361	368090.21	801106.64	11.57	0.26	0.69	0.106
941	15M 1552363	368103.03	801098.37	11.58	0.33	0.42	0.110
942	15M 1552365	368103.00	801097.20	11.58	0.26	0.75	0.106
943	15M 1552362	368101.08	801072.59	11.70	0.30	0.57	0.112
944	15M 1552364	368100.91	801071.45	11.70	0.39	0.58	0.291

VALVE/HYDRANT SCHEDULE			
ID	mE	mN	RL
FH1	368091.83	801108.72	11.50
GV1	368099.75	801046.79	11.77
GV2	368091.98	801109.40	11.47
SV1	368087.73	801047.15	11.86
SV2	368087.24	801047.47	11.88
SV3	368087.19	801046.98	11.88
SV4	368099.87	801046.13	11.80

PE PIPE DIMENSIONS				
TYPE	SIZE	STANDARD DIMENSION RATIO	MATERIAL	PRESSURE RATING
RIDERMAIN	63mm OD	SDR11	PE80	PN 12.5
CONNECTION	25mm OD	SDR11	PE80	PN 12.5

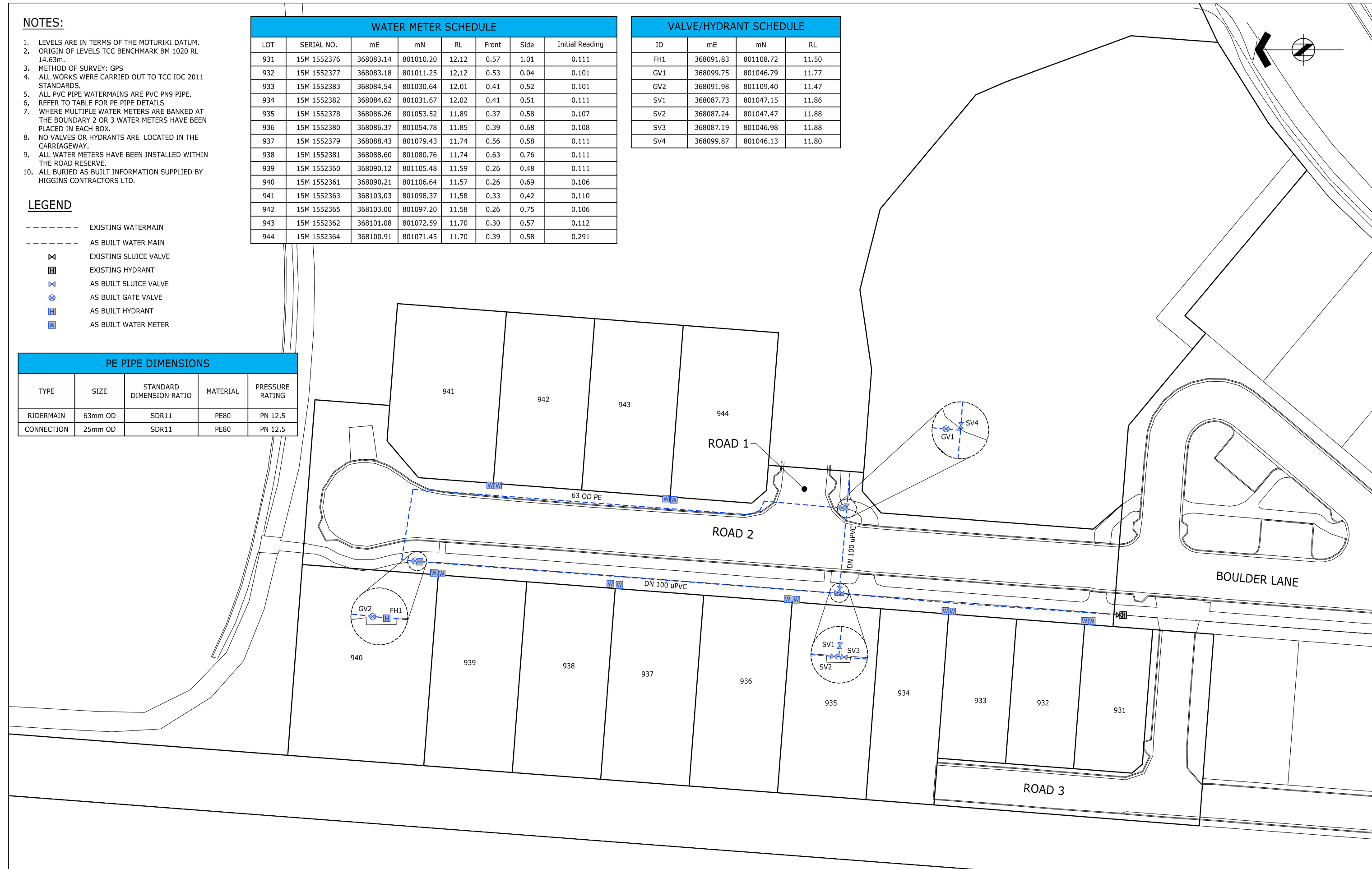

ORIGINATOR:	DATE:	SIGNED:	HEH
TSC	10.12.15		
DRAWN:	DATE:	SIGNED:	HEH
HEH	10.12.15		
CHECKED:	DATE:	SIGNED:	TSC
TSC	21.12.15		
APPROVED:	DATE:	SIGNED:	GPR
GPR	15.12.15		
BY:	DATE:	SIGNED:	GPR
	21.12.15		

ASSOCIATION OF CONSULTING ENGINEERS
NEW ZEALAND

ISO 9001 QUALITY ASSURED

TAURANGA OFFICE
LEVEL 1 HARRISON GRIERSON HOUSE
141 CAMERON ROAD TAURANGA 3110
T +64 7 578 0023
W www.harrisongrierson.com

HG

PROJECT: **Summit**
THE LAKES (2012) LIMITED, TAURANGA

TITLE: **STAGE 2P2
WATER RETICULATION AS BUILT PLAN
TCC IP 24551**

ISSUE STATUS:	AS BUILT	
PROJECT No:	SCALES:	A1
1510-137878-01	1:250 - A1 1:500 - A3	
DRAWING No:	REV	
137878-AB300	B	