

**NOTES:**

- LEVELS ARE IN TERMS OF THE MOTURIKI DATUM.
- ORIGIN OF LEVELS TCC BENCHMARK BM 1070 RL 55.865m.
- METHOD OF SURVEY: GPS
- ALL WORKS WERE CARRIED OUT TO TCC IDC 2011 STANDARDS.
- ALL RIDERMAINS ARE 63 OD PE UNLESS OTHERWISE SPECIFIED.
- ALL PVC PIPE WATERMAINS ARE PVC PN9 PIPE.
- REFER TO TABLE FOR PE PIPE DETAILS
- WHERE MULTIPLE WATER METERS ARE BANKED AT THE BOUNDARY 2 OR 3 WATER METERS HAVE BEEN PLACED IN EACH BOX.
- NO VALVES OR HYDRANTS ARE LOCATED IN THE CARRIAGEWAY.
- ALL WATER METERS HAVE BEEN INSTALLED WITHIN THE ROAD RESERVE.
- ALL BURIED AS BUILT INFORMATION SUPPLIED BY HIGGINS CONTRACTORS LTD.

PE PIPE DIMENSIONS				
TYPE	SIZE	STANDARD DIMENSION RATIO	MATERIAL	PRESSURE RATING
MAIN	125mm OD	SDR11	PE80	PN 12.5
RIDERMAIN	63mm OD	SDR11	PE80	PN 12.5
CONNECTION	25mm OD	SDR11	PE80	PN 12.5

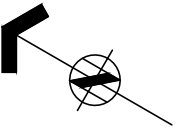

**LEGEND:**

- W AS BUILT WATER MAIN
- RM AS BUILT RIDER MAIN
- W EXISTING WATER
- AS BUILT WATER CONNECTION
- AS BUILT HYDRANT
- X AS BUILT SLUICE VALVE
- AS BUILT GATE VALVE
- AS BUILT WATER METER
- EXISTING HYDRANT
- X EXISTING SLUICE VALVE
- EXISTING GATE VALVE

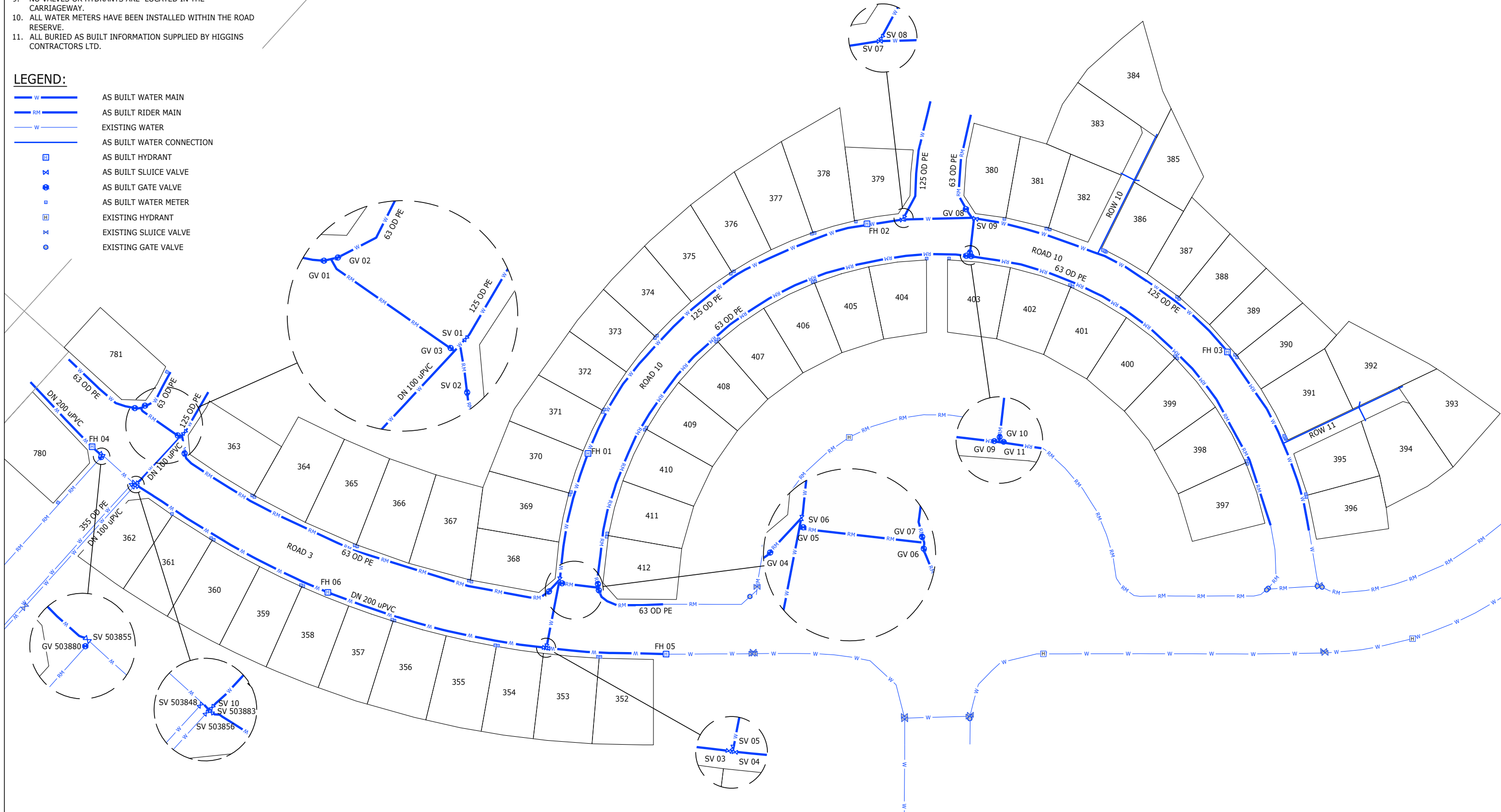

ORIGINATOR: RXD DATE: 12.09.16 SIGNED: [Signature]		PLOT BY: TRS PLOT DATE: 26.09.16		ASSOCIATION OF CONSULTING ENGINEERS NEW ZEALAND ISO 9001 QUALITY ASSURED	TAURANGA OFFICE LEVEL 1, 60 SPRING STREET TAURANGA 3110 T +64 7 578 0023 W www.harrisongrierson.com	PROJECT: <b>Summit</b> THE LAKES (2012) LIMITED, TAURANGA	TITLE: <b>STAGES 3EM          WATER RETICULATION AS BUILT PLAN          SHEET 1          TCC IP 101696</b>	ISSUE STATUS: <b>AS BUILT</b>	
DRAWN: TRS DATE: 12.09.16 SIGNED: [Signature]		SURVEY BY: [Signature] DATE: 28.09.16						PROJECT No: 1500-138804-01 SCALES: 1:625 - A3 1:1250 - A1	A1
CHECKED: RJM DATE: 28.09.16 SIGNED: [Signature]		SURVEY DATE: [Signature]		THIS DRAWING AND DESIGN REMAINS THE PROPERTY OF, AND MAY NOT BE REPRODUCED OR ALTERED, WITHOUT THE WRITTEN PERMISSION OF HARRISON GRIERSON CONSULTANTS LIMITED. NO LIABILITY SHALL BE ACCEPTED FOR UNAUTHORISED USE OF THIS DRAWING.		DRAWING No: <b>138804-AB301</b>		B	
B AS BUILT FINAL GPR 28.09.16 A DRAFT AS BUILT GPR 12.09.16 REF REVISIONS BY DATE GPR									